

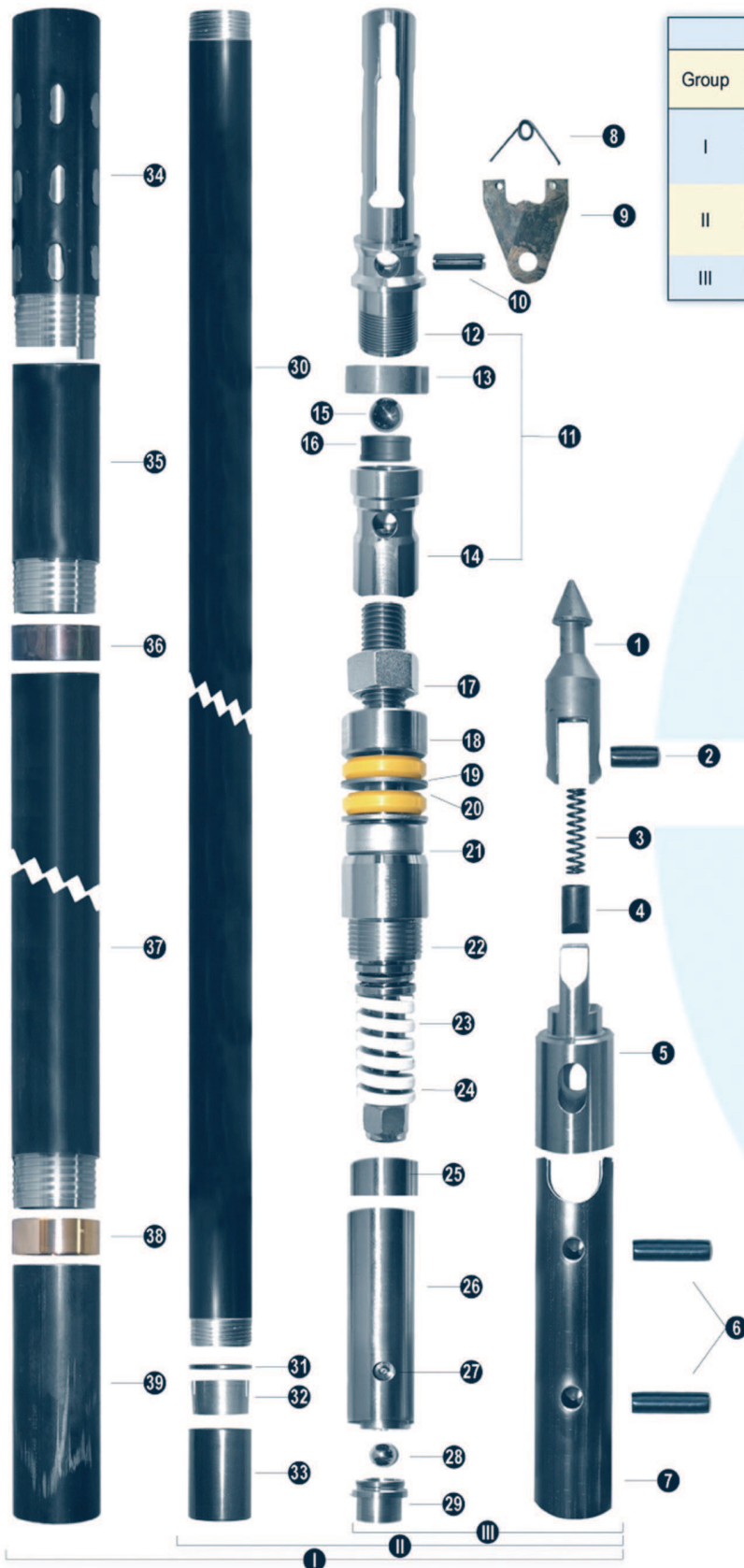

# WIRELINE CORE BARREL "Kunckle Head" Size : H



ASSEMBLIES				
Group	Description	Part No	Weight lb	kg
I	Core Barrel Assy FF			
	5'	WH0205	145.00	65.9
	10'	WH0210	214.50	97.2
II	Inner Tube Assy FF			
	5'	WH1205	60.50	27.4
	10'	WH1210	79.00	35.8
III	Head Assy FF	WH2002	41.25	18.7

1	Spearhead point	WBNH2201
2	Spiral pin (7/16" X 1")	WBNH2205
3	Compression spring	WBNH2202
4	Detent plunger	WBNH2203
5	Spearhead base	WH2204
6	Spring pin (2) (1/2" x 2 3/4")	WH2103
7	Latch retracting case	WH2206
8	Latch spring	WH2104
9	Latch (2)	WH2105
10	Spiral pin (1/2" x 2")	WN2103
11	Latch body assy	WH2909
12	Upper body	WH2909-1
13	Landing shoulder	WH2909-2
14	Lower body	WH2909-3
15	Steel ball 22 mm	WBNH2909-4
16	Landing indicator bushing	WBNH2909-5
17	Lock nut	WH2110
18	Spindel assy	WH2111
19	Shut-off valve (2)	WH2112U
20	Valve adjusting washer (2)	WH2113
21	Ball thrust bearing (2)	WH2114
22	Spindle bearing	WH2115
23	Ball thrust bearing	WN2114
24	Compression spring	WH2116
25	Self lock nut	WH2117
26	Inner tube cap assy FF	WH2119
27	Grease fitting	WB2120
28	Steel ball (7/8)	WN2121
29	Check valve body	WN2123
30	Inner tube 5'	ITH2125
30	Inner tube 10'	ITH2130
31	Stop ring	WH2132
32	Core lifter	WH2133
33	Core lifter case	WH2131
34	Locking coupling standard	WH2134
35	Adaptor coupling	WH2135
36	Landing ring	WH2136
37	Outer tube 5'	OTH2145
37	Outer tube 10'	OTH2150
38	Inner tube stabilizer	WH2139
39	Thread protector	WH2140